

**BROPHY BROS. BUILDING  
119-B HARBOR WAY**

SUSHI GO GO - LESSEE  
FIRST FLOOR PLAN  
198 SF

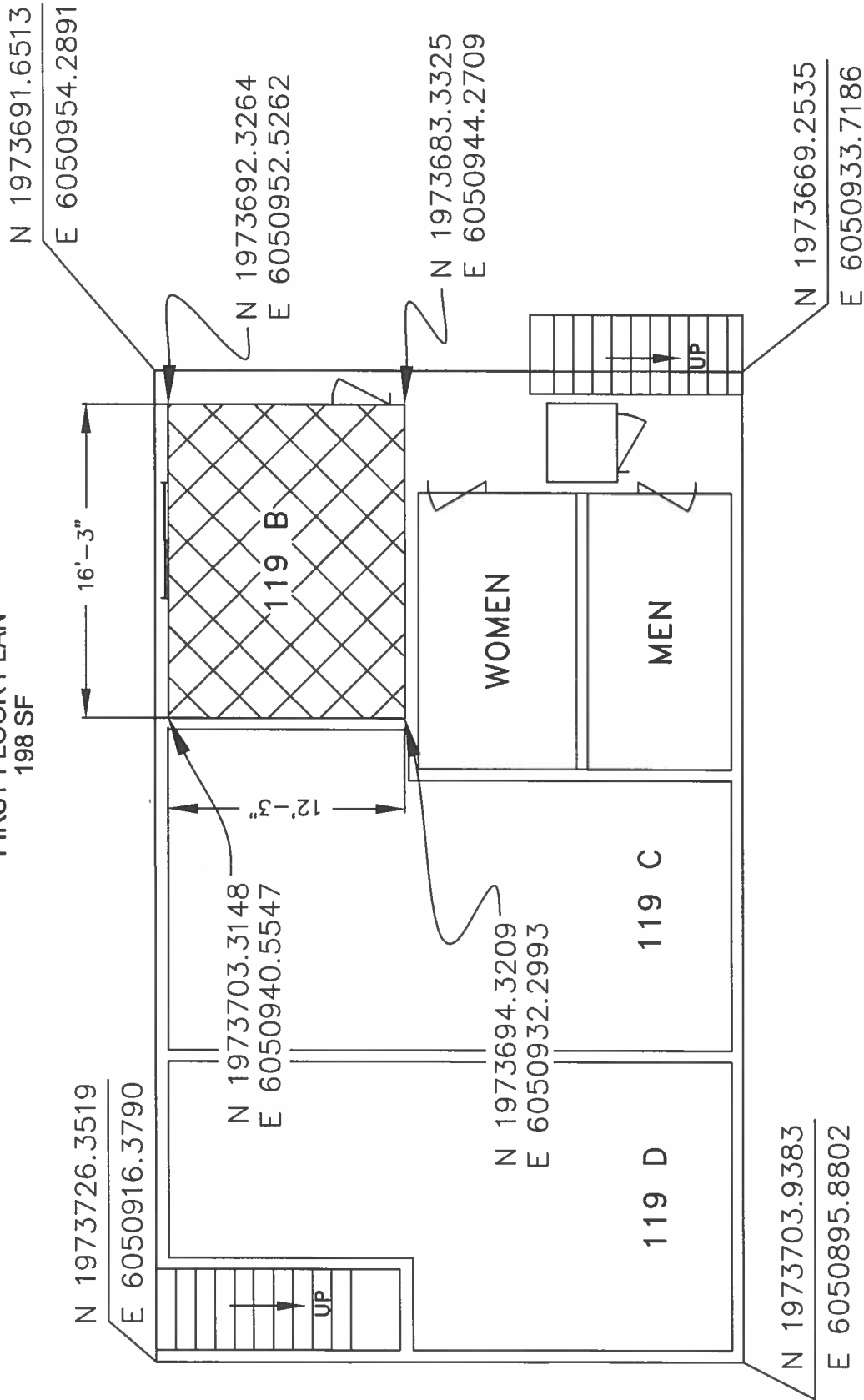

Project North

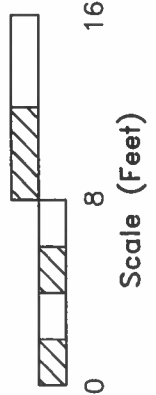

REVISIONS  
T. Barnette 1/28/01

DATE	1-1	DESIGNED BY	T. Geasch
REV	5/13/98	PROJECT	119-B HARBOR WAY
		CITY OF SANTA BARBARA	
		Waterfront Department	2 of 2

Sushi Go-Go  
Exhibit "A"