



CITY OF SANTA BARBARA

COUNCIL AGENDA REPORT

AGENDA DATE: November 15, 2016

TO: Mayor and Councilmembers

FROM: Transportation Planning, Public Works Department
Engineering Division, Public Works Department

SUBJECT: Permitting The Temporary Beachway Bridge Over Mission Creek

RECOMMENDATION:

That Council direct staff to work with the California Coastal Commission staff to permit the Beachway Bridge initially installed as temporary access over Mission Creek to remain after completion of the Cabrillo Bridge Replacement Project as a functional improvement to the multi-purpose path.

DISCUSSION:

Public Works is currently in the final stage of construction to replace the Cabrillo Boulevard Bridge over Mission Creek. The Cabrillo Boulevard Bridge Replacement Project (Project) included three stages of construction over two years to allow for continued vehicular, pedestrian, and bicycle circulation in the Waterfront. As a part of the phasing, a temporary Beachway Bridge was constructed south/downstream of the Project to provide continued pedestrian and cyclist circulation via the multi-purpose path known as the Beachway. The temporary pedestrian bridge also supports three utility lines during construction. These utility lines will be moved from the temporary bridge and relocated back onto Cabrillo Bridge upon completion of construction. Attachment 1 shows the Project area and the temporary Beachway Bridge alignment. Attachment 2 includes a photograph of the site.

The south side of Cabrillo Boulevard and adjacent Stearns Wharf have the highest pedestrian and cyclist volumes in the Waterfront. Additionally, surries and other rented non-motorized vehicles, rollerbladers, and joggers share the Beachway. The proposed alignment of the Beachway via the temporary bridge would provide for a greater separation between pedestrians and faster moving Beachway users, increasing the capacity of all users. The temporary bridge is located on park property and is compatible with and accessory to the purpose for which the park was dedicated.

Because of these benefits, during the final design stages of the Project, Public Works staff vetted the possibility of making the temporary Beachway Bridge permanent with the Planning Commission. Planning Commission agreed with this approach, but the California Coastal Commission (CCC) staff was not supportive because of their guidance policy on sea level rise.

Now that the temporary Beachway Bridge is in place, CCC staff can more readily see the coastal recreation and access benefits of the bridge. CCC is now open to reviewing a Coastal Development Permit amendment to allow the bridge to remain in place until such time that sea level rise or creek bank/coastal erosion requires the bridge to be removed. When the useful life of the bridge ends, the Beachway alignment would revert to the new Cabrillo Boulevard Bridge (previous alignment).

Staff has received some positive feedback from the community about the bridge, as well as confusion as to why it needs to be removed. Staff is recommending that Council direct staff to pursue a Coastal Development Permit amendment to allow the temporary bridge to remain.

Budget Considerations

The Project construction contract includes the construction and removal of the temporary bridge in the bid amount of approximately \$700,000. Public Works staff have informally discussed with the contractor their willingness to leave the temporary bridge in place without additional cost to the City, in exchange for relieving the Contractor of the costs to remove the bridge and restore the area to its original condition. If and when the temporary bridge needs to be removed it will be done at the City's expense. Public Works staff estimate the cost of bridge removal, constructing a new Beachway connection, and associated restoration work to be approximately \$100,000.

ATTACHMENTS: 1. Cabrillo Boulevard Bridge Replacement Project Area
2. Photograph of Project Site

PREPARED BY: Robert J. Dayton, Principal Transportation Planner/mj
Adam Hendel, Principal Civil Engineer

SUBMITTED BY: Rebecca J. Bjork, Public Works Director

APPROVED BY: City Administrator's Office

- Notes:**
1. For Complete Right of Way Information, See Maps in City Office.
 2. See Typical Sections, Profiles, Construction Details, and Quantities Sheets for Additional Information.
 3. See Special Provisions regarding preservation of survey monuments.
 4. A Portion of the Rusty's Pizza Building, 13 E. Cabrillo Blvd., will be Demolished to make room for the Construction of the Bridge and Transition Walls. See "Transition Wall Layout" and "Architectural Plans" for more Details.
 5. Temp HMA DiKE as Directed by the Engineer.

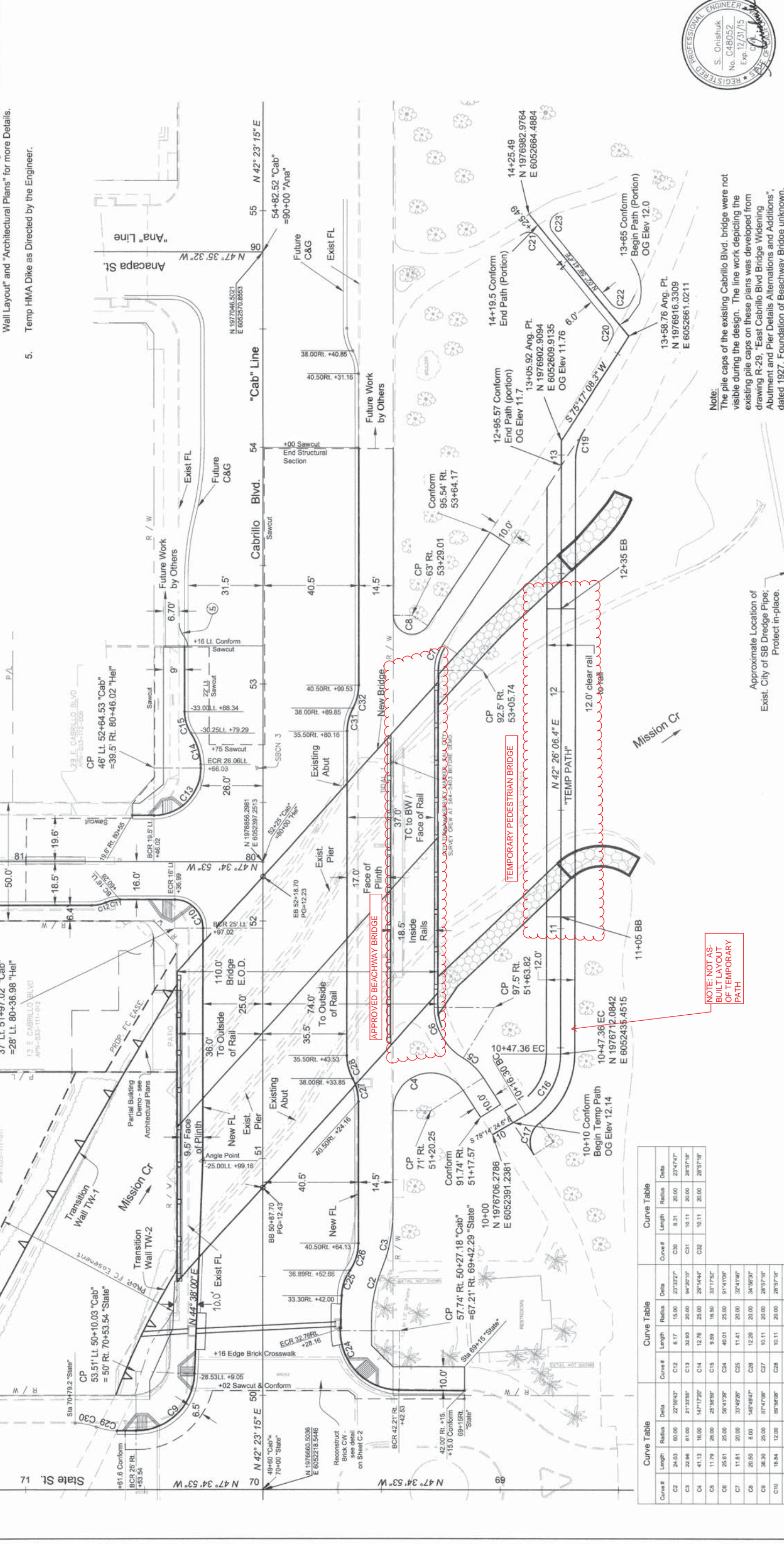

Note:
The pile caps of the existing Cabrillo Blvd. bridge were not visible during the design. The line work depicting the existing pile caps on these plans was developed from drawing R-29, "East Cabrillo Blvd Bridge Widening Abutment and Pier Details Alterations and Additions", dated 1927. Foundation of Beachway Bridge unknown.

Approximate Location of
Exist. City of SB Dredge Pipe;
Protect in-place.

NOTE: NOT AS-BUILT LAYOUT OF TEMPORARY PATH

Curve Table				Curve Table				Curve Table			
Curve #	Length	Radius	Delta	Curve #	Length	Radius	Delta	Curve #	Length	Radius	Delta
C2	24.03	60.00	22°55'47"	C12	6.17	15.00	23°33'27"	C20	8.31	20.00	23°47'47"
C3	22.96	81.00	21°33'55"	C13	32.83	20.00	94°29'19"	C21	10.11	20.00	28°57'16"
C4	41.13	16.00	147°17'20"	C14	12.76	25.00	29°14'44"	C22	10.11	20.00	28°57'16"
C5	11.79	26.00	25°58'59"	C15	9.59	16.50	33°17'52"	C23	10.11	20.00	28°57'16"
C6	25.61	25.00	58°41'36"	C16	40.01	25.00	91°41'09"	C24	10.11	20.00	28°57'16"
C7	11.81	20.00	33°49'26"	C17	11.41	20.00	32°41'46"	C25	10.11	20.00	28°57'16"
C8	20.50	8.00	148°49'47"	C18	12.20	20.00	34°56'30"	C26	10.11	20.00	28°57'16"
C9	38.30	25.00	87°47'08"	C19	10.11	20.00	28°57'16"	C27	10.11	20.00	28°57'16"
C10	18.84	12.00	89°58'08"	C20	10.11	20.00	28°57'16"	C28	10.11	20.00	28°57'16"
C11	6.17	15.00	23°33'27"	C21	8.66	20.00	24°31'36"	C29	8.66	20.00	24°31'36"

BENGAL ENGINEERING
250 BIG SUR DRIVE, GOLETA, CA 93117
(805) 563-0788
Project Eng. *S. Orishuk*

DESIGN: *S.O.*
DRAWN: *E.P.B.*
CHECKED: *J.D.W.*
FLD.BK. NO. _____
PAGE: _____
ATLAS: _____

DATE: **JUN 11 2014**
APPROVED: _____

Cabrillo Boulevard Bridge (Replacement)
at Mission Creek

Original Scale: 1" = 20'
Is in Inches

Scale: 1" = 20'
L-1

CITY OF SANTA BARBARA
PUBLIC WORKS DEPARTMENT - ENGINEERING DIVISION

Approved: *Pat Kelly* City Engineer
Date: **JUN 11 2014**

SHT. 4 OF 25 SHTS.
DWG. NO. C-1-4200

CITY OF SANTA BARBARA
PUBLIC WORKS DEPARTMENT - ENGINEERING DIVISION

Approved: *Pat Kelly* City Engineer
Date: **JUN 11 2014**

SHT. 4 OF 25 SHTS.
DWG. NO. C-1-4200

BEACHWAY

TEMPORARY PEDESTRIAN BRIDGE

APPROVED BEACHWAY BRIDGE

